

ISOTEC: EFFICIENCY AND SAVINGS FOR THE ENTIRE ENVELOPE OF NEW BUILDINGS AND BUILDINGS TO BE RENOVATED

ISOTEC®



ISOTEC® PARETE



ISOTEC® LINEA



The wall and roof thermal insulating system in rigid polyurethane foam covered in embossed aluminium on both sides.



THERMAL INSULATION (POLYURETHANE)



NO THERMAL BRIDGES



SECOND WATERPROOFING LAYER



ENERGY SAVING



VENTILATION



MAXIMUM COMPATIBILITY



FAST AND COST-EFFECTIVE INSTALLATION



ISOTEC®

The thermal insulating system for roofs.



- COATED ON BOTH SURFACES WITH AN EMBOSSED ALUMINIUM SHEET
 - CROSSWISE DOVETAIL
 - STANDARD PITCH FROM 28° TO 42°; smaller and larger pitches, on request
 - SELF-EXTINGUISHING, RIGID POLYURETHANE FOAM (PUR OR PIR)
 - LONGITUDINAL BATTEN
 - PERFORATED STEEL STIFFENER IN AN ALUMINIUM, ZINC AND SILICON ALLOY
- 3900 mm
-
- ISOTEC THICKNESSES: 60, 80, 100 and 120 mm
 - ISOTEC XL/ISOTEC XL PLUS THICKNESSES: 80, 100, 120 and 160 mm

- ✓ **EXTREMELY FAST INSTALLATION** → reduction of installation costs, as the system integrates a series of functions of the roof package (vapour barrier, insulation, second-stage waterproofing, ventilation, tile-bearing stiffener).
- ✓ **EXTREMELY LIGHTWEIGHT PANEL** → minimal overload on existing structures.
- ✓ **MAXIMUM COMPATIBILITY WITH ALL TYPES OF ROOFS**, both tiles (pantiles, inter-locking tiles, cement tiles, etc.) and other types of roofing membranes (metal sheets, fibreglass, etc.).
- ✓ **REDUCTION OF HEATING COSTS IN WINTER AND COOLING COSTS IN SUMMER.**
- ✓ **CONSTANT PERFORMANCES OVER TIME (POLYURETHANE).**
- ✓ **LONGER DURATION OF THE ROOF, DUE TO THE VENTILATION SYSTEM.**





The thermal insulating system for ventilated facades.

■ CROSSWISE DOVETAIL



■ PITCH FROM
250 TO 730 mm

■ SELF-EXTINGUISHING,
RIGID POLYURETHANE FOAM

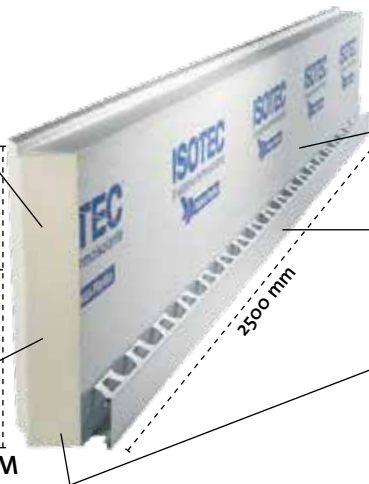

■ COVERED IN EMBOSSED ALUMINIUM
ON BOTH SIDES

■ STIFFENER IN PROTECTED STEEL

■ LONGITUDINAL BATTEN

■ THICKNESSES: 60, 80, 100, 120 and 160 mm



ISOTEC[®]
PARETE BLACK

Also available in the ISOTEC PARETE BLACK version (PUR).
Reaction to fire: euroclass Bs2, d0

- ✓ EXTREMELY FAST INSTALLATION → reduction of installation costs.
- ✓ EXTREMELY ADAPTABLE TO ALL TYPES OF LOAD-BEARING STRUCTURES AND TO ALL CLADDING ELEMENTS ON THE MARKET.
- ✓ INSULATION FROM THE OUTSIDE → less invasive.
- ✓ REDUCTION OF HEATING COSTS IN WINTER AND COOLING COSTS IN SUMMER.
- ✓ CONSTANT PERFORMANCES OVER TIME (POLYURETHANE).
- ✓ LONGER DURATION OF THE EXTERNAL CLADDING, DUE TO THE VENTILATION SYSTEM.
- ✓ EXTREMELY LIGHTWEIGHT AND MANAGEABLE (length reduced to 2500 mm) FOR INSTALLATION OPERATIONS ON SCAFFOLDING.



The thermal insulating system for non-ventilated walls and roofs.



CTL 180/EN - REV.0 11.19

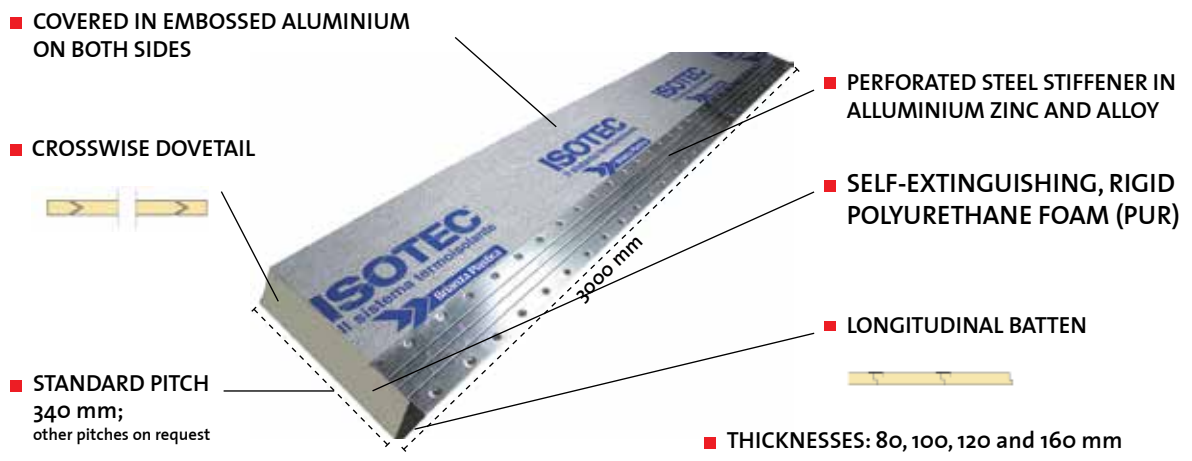

- ✓ EXTREMELY FAST INSTALLATION → reduction of installation costs.
- ✓ EXTREMELY LIGHTWEIGHT PANEL → minimal overload on existing structures.
- ✓ CAN BE USED FOR ROOFS AND FACADES.
- ✓ IN ROOFING FOR SEAMED SHEET METAL SYSTEMS; FIXING HOLES FOR BRACKETS.
- ✓ CONSTANT PERFORMANCES OVER TIME (POLYURETHANE).



CE marking in accordance with EC Regulation 305/2011, UNI EN 13165:2016 and UNI EN 13172:2012 - System 3; notified body: CSI S.p.A. (0497).



Brianza Plastica SpA - Via Rivera, 50 - 20841 Carate Brianza - Italy
 T. +39 0362 91601 - Fax +39 0362 990457
 sales-insulation@brianzaplastica.it - www.brianzaplastica.it

